





















Jeep

OK

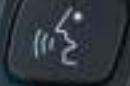



Jeep

SET+
CANCEL RES
SET-

DO NOT PRESS

AIRBAG



ON OFF
P
D
R
L



W 2.0 Vehicle Info 80°F

39 39
39 38
psi

Tyre pressure
P
26 km

H
C
F
E

The central display shows a top-down view of the vehicle with tire pressure readings: front-left 39 psi, front-right 39 psi, rear-left 39 psi, and rear-right 38 psi. Below this, it displays 'Tyre pressure P' with a bar graph and '26 km'. On the left, a fuel gauge shows a level between C and H. On the right, a temperature gauge shows a level between E and F.





W 2.0 Vehicle Info 80°F

192°F

Coolant Temp

P 26 km

F

E

C





W 2.0 Vehicle Info 80°F



Oil Pressure
P
26 km





W 2. Vehicle Info 80°F



Battery Voltage
P
26 km





2H
4H
4L
N

W

3.0

Off Road

80°F



Drivetrain

P

26 km



ON OFF
OFF ON
OFF ON



W 3.0 Off Road 80°F

H C F E

Pitch & Roll
0° 0°

P
26 km

The central instrument cluster displays vehicle status including compass, gear, off-road mode, temperature, fuel level, and pitch/roll sensors.



10100
ON
OFF

Additional controls and labels visible at the bottom right of the dashboard.

DO NOT PRESS

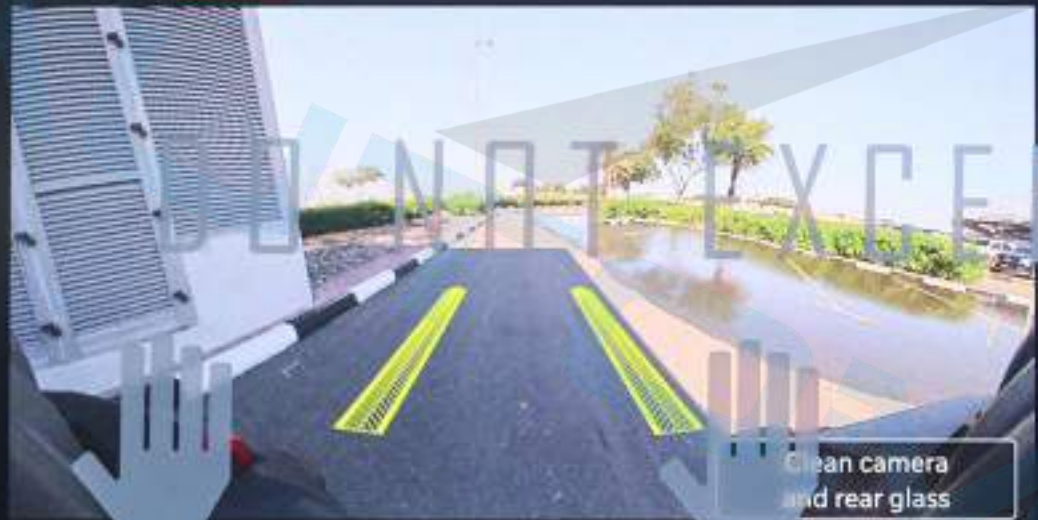

Clean camera and rear glass

Jeep



DO NOT PRESS



EXCELLED Jeep





Home



Media



Comfort



Nav



Phone



Vehicle



Apps

LO



75°
OUT

10:53



EmaratFM



69°

Q Search

DO NOT EXCEED 10Kg

30

40



40

Manama Street

22 Street

31 Street

24d Street

27c Street

25c Street

23 Street

36c Street

Nadd AliHamar-Road

DO NOT PRESS



Home



Media



Comfort



Nav



Phone



Vehicle



Apps

LO



75°
out

10:53



EmaratFM



69°

Favorites

All

Media

Comfort

Nav

Phone

AM

AM Radio



Audio Settings



Auxiliary Cable



Bluetooth

DAB

DAB



Device Manager

FM

FM Radio



Media



Home



Media



Comfort



Nav



Phone



Vehicle



Apps

LO



75°
OUT

10:53



EmaratFM



69°

DO NOT EXCEED 10 Kg



Heat



Heat

Max A/C

A/C

Rear

Sync

Off



1

2

3



4

5

6

7

Auto



DO NOT PRESS

- Home
- Media
- Comfort
- Nav
- Phone
- Vehicle
- Apps

LO | 75° OUT | 10:55 | EmaratFM | 69°

Favorites

All

Media

Comfort

Nav

Phone

Comfort

Driver Heat

Heated Wheel

Psgr Heat

DO NOT EXCEED 100 Km/h



LO [Icons] 75° OUT | 10:52 EmaratFM | 69°

Dashboard

Controls

Settings

DO NOT EXCEED 10Kg
Mirror Dimmer

DO NOT EXCEED 10Kg
Forward Facing Camera

DO NOT EXCEED 10Kg
Rear View Camera

DO NOT EXCEED 10Kg

Home

Media

Comfort

Nav

Phone

Vehicle

Apps

DO NOT PRESS



DO NOT PRESS



Home



Media



Comfort



Nav



Phone



Vehicle



Apps

LO



75°
OUT

10:52



EmaratFM



69°

Dashboard

Controls

Settings



OFFROAD
PAGE

DO NOT EXCEED 100g





Home



Media



Comfort



Nav



Phone



Vehicle



Apps

LO



10:53

FM EmaratFM

69°

Favorites

All

DO NOT EXCEED 10Kg



Device Manager



Off Road Pages

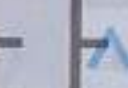

Android Auto



DO NOT PRESS

- Home
- Media
- Comfort
- Nav
- Phone
- Vehicle
- Apps

LO 75° OUT | 10:53 EmaratFM | 69°

< Off Road Pages

Vehicle Dynamics

Steering Angle: 10K

Transfer Case: Unlocked

Pitch & Roll

Front Camera

Accessory Gauges

Sway Bar: Connected

Front Axle Locker: Unlocked

Rear Axle Locker: Unlocked

2H 55° 25°10'07" N Altitude: -32 m



DO NOT PRESS

- Home
- Media
- Comfort
- Nav
- Phone
- Vehicle**
- Apps

LO 75° OUT | 10:53 EmaratFM | 69°

Off Road Pages

Vehicle Dynamics

Accessory Gauges

- Oil Temp: 147°F
- Coolant Temp: 147°F
- Oil Pressure: 15psi
- Pitch & Roll
- Front Camera
- Trans Temp: 73°F
- Battery Voltage: 12.0V

2H 55° 25°10'07" N Altitude: -32 m

DO NOT PRESS

- Home
- Media
- Comfort
- Nav
- Phone
- Vehicle**
- Apps

LO 75° OUT | 10:53 EmaratFM | 69°

< Off Road Pages

DO NOT EXCEED 10kg

Vehicle Dynamics

Accessory Gauges

Pitch & Roll

Front Camera

2H 55° 01' 25°10'07" N Altitude: -32 m

0° Pitch

0° Roll



DO NOT PRESS

- Home
- Media
- Comfort
- Nav
- Phone
- Vehicle
- Apps

LO 75° OUT | 10:54 EmaratFM | 69°

· Favorites All

Media

Comfort

Nav

Phone

USB 1 USB 2

DO NOT PRESS



- Home
- Media
- Comfort
- Nav
- Phone
- Vehicle
- Apps

LO | 75° OUT | 10:55 | FM EmaratFM | 69°

Favorites

All

- Nav
- Phone
- Vehicle
- System

- Audio Settings
- Controls
- Forward Cam
- Mirror Dimmer
- Off Road Pages
- Near View Camera
- Select. Tire Fill
- Settings

DO NOT PRESS

- Home
- Media
- Comfort
- Nav
- Phone
- Vehicle
- Apps

LO [Icons] 75° OUT | 10:55 EmaratFM | [Icon] 69°

Favorites All

DO NOT EXCEED 100 Km/h

Nav Phone Driver Profiles Software Updates Stored Notifications

Vehicle

System

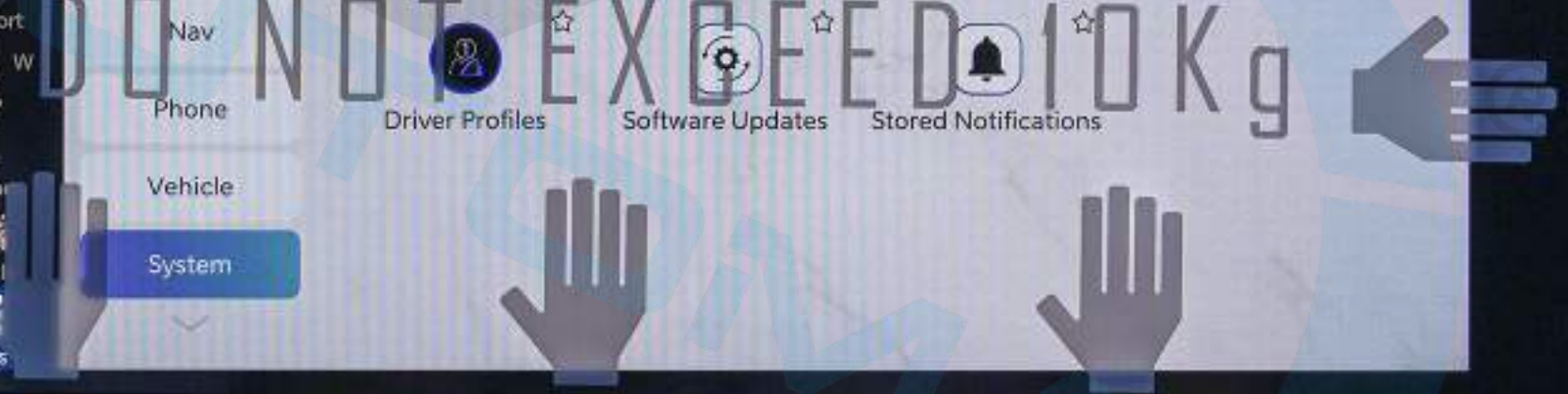



Главная



Медиа



Комфорт



Nav



Тел.



Автом.



Прил.

Низ.



75°



10:55



EmaratFM



69°

Поиск

DO NOT EXCEED 10Kg



40

DO NOT PRESS

DO NOT PRESS

- Главная
- Медиа
- Комфорт**
- Nav
- Тел.
- Автом.
- Прил.

Низ. 75° | 10:55 EmaratFM | 69°

DO NOT EXCEED 10Kg

Макс. A/C

A/C

Экономный

Синхр.

Off

1

2

3

4

5

6

7

Авт.



- Главная
- Медиа
- Комфорт
- Nav
- Тел.
- Автом.
- Прил.

Низ. 75° 10:55 EmaratFM 69°

Приборная доска

Элементы управления

Настройки

- Дисплей
- Мой профиль
- Безопасн. и помощь в упр.
- Время и дата

Язык (Русский (Россия))

Режим дисплея

Яркость дисплея в ночном режиме

Яркость дисплея в дневном режиме

Режим темы

Автоматический

10

10

Светл.

Автом.

Дневной

Автом.

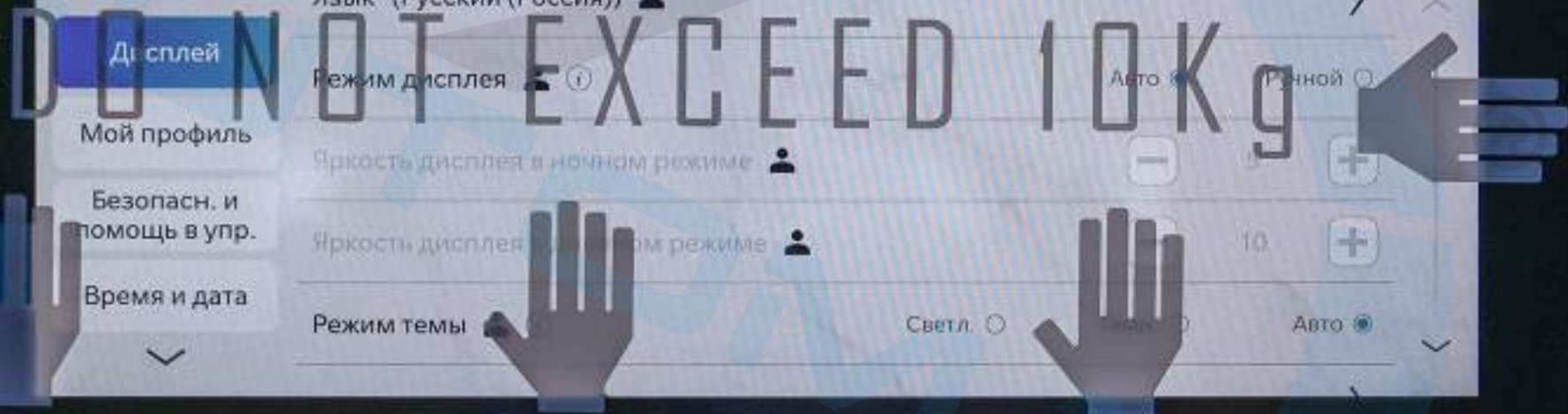

- Главная
- Медиа
- Комфорт
- Nav
- Тел.
- Автом.**
- Прил.

Низ. 75° 10:56 EmaratFM 69°

Off Road Pages

Vehicle Dynamics
Accessory Gauges

DO NOT EXCEED 10km/h

- Pitch & Roll
- Front Camera

2H 55 25°10'07" C Высота -32 m

- Главная
- Медиа
- Комфорт
- Nav
- Тел.
- Авто
- Прил.

Низ. 75° | 10:56 EmaratFM | 69°

Избранные Все

Медиа

Комфорт

Nav

Тел.

Комфорт

Обог. пасс.

Обог. водит.

Обогрев. рул. колесо

DO NOT PRESS

- Главная
- Медиа
- Комфорт
- Nav
- Тел.
- Автом.
- Прил.

Низ. 75° 10:56 EmaratFM 69°

Избранные Все

DO NOT EXCEED 10Kg

- Медиа
- Комфорт
- Nav
- Тел.





DO NOT PRESS

- Главная
- Медиа
- Комфорт
- Nav
- Тел.
- Авто
- Прил.

Низ. 75° | 10:56 EmaratFM | 69°

Избранные Все

DO NOT EXCEED 10Kg

Медиа

Комфорт

Nav

Тел.





Главная



Медиа



Комфорт



Nav



Тел.



Авто



Прил.

Низ.

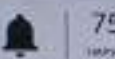

75°

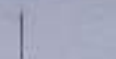

10:56

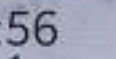

69°



Источники

Воспроизведение

Просмотр

Настр. аудио

Баланс/
Фейдер

Эквалайзер

Гром. в завис.
от скорости

Компенсац.
ромкости АиХ



Volume knob with power icon and "VOLUME" text.

FRONT	Icon: Fan with sun	Up arrow	OFF	Down arrow	MODE	A/C
Icon: Fan with sun	Icon: Fan with sun	Down arrow	AUTO	Up arrow	Icon: Fan with sun	Icon: Car with fan

MUTE A OFF OFF P OFF SCREEN OFF

Icon: Triangle with exclamation mark

TUNE BROWSE ENTER SCROLL knob

Handbrake with "P" icon

Icon: Car with fan

Icon: Car with fan





FRONT+REAR

REAR ONLY

OFF
ROAD+

SWAY
BAR

+ REAR

ONLY

**OFF
ROAD+**

**SWAY
BAR**

AU

AUX

AUX 1

AUX 3

AUX 2

AUX 4

















///ALPINE







RUBICON

A close-up photograph of the front left side of a white Jeep Rubicon. The focus is on the hood and the front fender. A prominent badge with the word "RUBICON" in a bold, black, sans-serif font with a red outline is mounted on the fender. The hood features a large, black, rectangular air intake vent. The background is slightly blurred, showing other vehicles in a parking lot. A faint, semi-transparent watermark "ALUMINA" is visible across the center of the image.

Jeep

WRANGLER



Jeep®

|||| 00110388FYC/M-7450

ASH 23



43R-0120269



1001488



23



SAHACOUSTIC

TRANSP. 70% MIN.

MADE IN USA

PG2519033AA

CORNING | Gorilla Glass







Manufacturer Name FCA US LLC	
Model Year 2024	Label No. 160987
FCA US LLC JEEP WRANGLER UNLIMITED 3.6L SUV 4WD 4Doors	
Fuel Economy اقتصاد الوقود	
<div style="display: flex; justify-content: space-between;"> <div style="width: 40%;"> <p>Excellent ممتاز</p> <p>Very Good جيد جداً</p> <p>Good جيد</p> <p>Average متوسط</p> <p>Poor سيء</p> <p>Very Poor سيء جداً</p> </div> <div style="width: 5%; text-align: center;"> <p>9.4</p> </div> </div>	
 هيئة التقييس <small>مجلس التعاون دول الخليج العربية GCC Mandate Issuing Organization</small>	Fuel Type بنزين Gasoline Euro IV
	Fuel Economy 9.4 km/L
	Vehicle Class Light Truck
	
إزالة أو تغطية أو إتلاف هذه البطاقة قبل البيع يعرض للملاحقة القانونية Removing, covering or damaging this label before sale is punishable by law	
	









لمشاهدة صورة السيارة بزاوية 360 درجة إضغط على الصورة أعلاه

Для просмотра автомобиля в формате 360°, пожалуйста, нажмите на фото выше.

To view the 360° degree please press on the picture above

2024 JEEP WRANGLER UNLIMITED RUBICON XTREME V6 3.6L GCC 0km

Бренд: Jeep

Brand: Jeep

الماركة جيب

Категория: Wrangler Unlimited

Category : Wrangler Unlimited

الفئة: رانجلر أنلملتد

Модель: Rubicon Xtreme

Model : Rubicon Xtreme

الموديل: روبيكон اكستريم

Год: 2024

Year: 2024

السنة: 2024

Километров: 0 Km

Kilometers: 0 Km

كيلومترات: 0 كم

Двери: 4 Doors

Doors: 4 Doors

عدد الأبواب: أربعة أبواب

Цвет: Earl

Color: Earl

اللون : Earl

Цилиндр: 6 Cylinders

Cylinder: 6 Cylinders

عدد الأسطوانات: 6 أسطوانات

Лошадиные силы: 285 HP

Horsepower: 285 HP

عدد الأحصنة: 285 حصان

Трансмиссия: Автоматическая

Transmission: Automatic

نوع النقل : نقل أوتوماتيكي

Топливо: Бензин

Fuel: Gasoline

المواصفات الإقليمية: خليجية

4X4

4 Wheel Drive 4X4

نوع الوقود: بنزين

دفع رباعي 4X4

2024 JEEP WRANGLER UNLIMITED RUBICON XTREME V6 3.6L GCC 0km

NAPPA LEATHER SEATS

BLACK

MIDDLE EAST EQUIPMENT GROUP

XTREME 35 TIRE PACKAGE

CONVENIENCE GROUP

TECHNOLOGY GROUP

SAFETY GROUP

SMOKER'S GROUP

FMVSS MIDDLE EAST GROUP

AUX BATTERY

SELEC-SPEED (TM) CONTROL

ANTI-LOCK 4-WHEEL DISC PERF BRAKES

PREMIUM DOOR TRIM PANEL

MOPAR HARDTOP HEADLINER

FREEDOM PANEL STORAGE BAG

REMOVABLE ASH TRAY

LEATHER WRAPPED PARK BRAKE HANDLE

LEATHER WRAPPED SHIFT KNOB

MOPAR JACK SPACER

#1 SEAT FOAM CUSHION

ALL AUTOMATIC TRANSMISSIONS

8-SPD AUTO 850RE TRANS (MAKE)

4:1 ROCK-TRAC HD FULL TIME 4WD SYS

4.56 REAR AXLE RATIO

3.6L V6 24V VVT ENGINE UPG I W/ESS

SOLAR CONTROL GLASS

REAR WINDOW DEFROSTER

REAR VIEW AUTO DIM MIRROR

BODY COLOR 3-PIECE HARD TOP

200 KPH PRIMARY SPEEDOMETER

REAR WINDOW WIPER/WASHER

CIGAR LIGHTER

230V AUXILIARY POWER OUTLET

GPS NAVIGATION

AIR FILTERING

HEATED FRONT SEATS

POWER 4-WAY DRIVER LUMBAR ADJUST

POWER 4-WAY PASSENGER LUMBAR ADJUST

DRIVER SEAT - POWER ADJUST 8-WAY

FRT PASS SEAT - POWER ADJUST 8-WAY

2024 JEEP WRANGLER UNLIMITED RUBICON XTREME V6 3.6L GCC 0km

EXTERIOR MIRRORS W/ARABIC LETTERING
AUTO HIGH BEAM HEADLAMP CONTROL
REAR FOG LAMPS
FRONT WIDE LICENSE PLATE BRACKET
WRANGLER DECAL
BODY COLOR RUBICON HIGHLINE FLARE
EXPORT EMISSIONS
U.S. EMISSIONS W/OBD 1
ENGINE OIL COOLER
HEATED STEERING WHEEL
ADAPTIVE CRUISE CONTROL W/STOP
WHEEL FLARE EXTENSIONS
EARL CLEAR COAT
ALPINE PREMIUM AUDIO SYSTEM
APPLE CARPLAY
DISASSOCIATED TOUCHSCREEN DISPLAY
GOOGLE ANDROID AUTO
12.3" TOUCHSCREEN DISPLAY
DIGITAL AUDIO BROADCASTING
INTEGRATED CENTER STACK RADIO

ALL R1 HIGH RADIOS
35" TIRE SUSPENSION
LT315/70R17C 113/110S TIRES
BF GOODRICH BRAND TIRES
UCONNECT 5 NAV W 12.3" DISP(ROW+DAB)
17X8.0 MACHINED WHEELS W/BLK POCKETS
ALL ALUMINUM WHEELS
PARKSENSE REAR PARK ASSIST SYSTEM
BLIND SPOT AND CROSS PATH DETECTION
REMOTE START SYSTEM
TIP START
MOPAR HINGE-GATE REINFORCEMENT
MOPAR TIRE RELOCATION KIT
STOP-START DUAL BATTERY SYSTEM
LOCK FUEL CAP W/ DISCRIMINATOR
ARABIC LANGUAGE
INTEGRATED OFF-ROAD CAMERA
INTEGRATED VOICE COMMAND W/BLUETOOTH
MANUF STATEMENT OF ORIGIN
4 ADDITIONAL GALLONS OF GAS

2024 JEEP WRANGLER UNLIMITED RUBICON XTREME V6 3.6L GCC 0km

BEAD-LOCK

Gorilla Glass Windshield

NAPPA LEATHER SEATS

Зимний Пакет

Подогрев Сидений

Рулевое Колесо с Подогревом

Боковые Зеркала с Подогревом

Дистанционный Запуск Двигателя

Система Мониторинга Слепых Зон

Бесключевой Доступ

Регулировка Режимов Вождения

Адаптивный Круиз-контроль

камера переднего вида

Камера Заднего Вида

Блокировка Дифференциала

ALPINE Премиальная Мультимедийная Система

Датчик Давления в Шинах

Система «Старт-Стоп»

12.3 Сенсорный Экран

Apple CarPlay + Android Auto

2024 JEEP WRANGLER UNLIMITED RUBICON XTREME V6 3.6L GCC 0km

الأداء:

ناقل حركة أوتوماتيكي ب 8 سرعات
سعة المحرك: 3.6 لتر
عدد الأسطوانات: 6 أسطوانات
عدد الأحصنة: 285 حصان
العزم: 353 نيوتن/متر
دفع رباعي

* المواصفات الإضافية:

BEAD-LOCK
Gorilla Glass Windshield
Off-Road Pages
مراتب سوداء من جلد النابا
مثبت سرعة تكييفي
نظام الدفلوك Differential Lock
خاصية الثبات الإلكتروني SWAY BAR
خاصية الطرقات الوعرة Off-Road Plus
كاميرا أمامية + خلفية
وضعية قيادة متعددة
نظام البطارية المزدوج للبدء والتوقف
خاصية الكشف عن النقطة العمياء
عوازل حرارية للسقف
نظام صوتي متقدم من Alpine
خاصية تدفئة المراتب
خاصية تدفئة المقود
خاصية تسخين المرايا الجانبية

2024 JEEP WRANGLER UNLIMITED RUBICON XTREME V6 3.6L GCC 0km

دخول بصمة
التشغيل عن بعد
نظام تحديد المواقع والملاحة
وسائد هوائية أمامية
مآخذ كهربائية إضافية
فرامل متقدمة عالية الأداء
تكييف هواء مع تحكم تلقائي بدرجة الحرارة
عجلات قياس 17 بوصة

نظام للمساعدة على الركن الخلفي
شاشة كبيرة تعمل باللمس مقاس 12.3 بوصة
آمر صوتي متكامل مع بلوتوث
مثبت سرعة
إنارة LED
اللغة العربية
مراتب كهربائية متعددة الوضعيات
أبل كاربلاي + أندرويد أوتو

AUTOMAX®

The Boutique Of Muscle Cars, Truck Fanatics & German Automotive Experts.



تتکلم اللغة العربية

WE SPEAK ENGLISH

ON PARLE LE FRANCAIS

Nosotros hablamos español

мы говорим по-русски

biz o'zbek tilida

gaplashamiz

हम हिंदी बोलते हैं



automaxgroup.me



automax group



automax.dxb



Automax_LLC



+971 54 279 8990



automax.dxb



automax.dxb



automax.dxb



automax_dxb



automax group L.L.C

New Auto Market - Dubai - United Arab Emirates

 **Directions**